



MultiTable® Single Monitor Arm



DIMENSIONS AND SPECS:

Colors



Materials

Powder coated, aluminum alloy

Dimensions (per arm)

Height Adjustable Range: 12" | Low: 7" | High: 19"
Monitor Extension: 22" | Retraction: 4"
Monitor Tilt: +25°/-90°
Monitor Rotation: +90°/-90°
Weight Capacity: Min. 6.5 lbs. | Max. 17.6 lbs.
Desk Clamp Thickness: 0.6" - 3" thick

*Note: Monitor Height/Weight May Limit Size.

Features

- Easily raises your monitor off your desk and securely attaches it to your workstation
- Includes both desk clamp and grommet mount alternative, with an integrated cable management system
- Compatible with VESA 75mm and VESA 100mm mounts
- Features a 180-degree lockout function
- Curved Monitors are not Recommended for this Product. Please Contact Us for More Details

Warranty

5-year limited

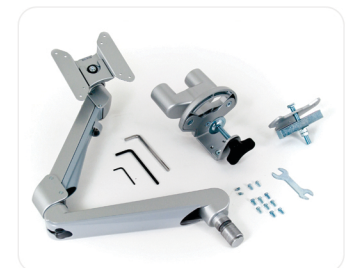
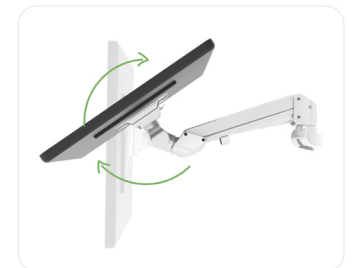
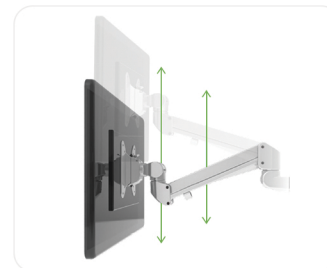

If you experience neck and back discomfort from looking down at your screen all day at work, let MultiTable help you feel better with our easy to adjust monitor arms. They improve the ergonomics of your monitors by placing them in the best possible viewing position for reduced eye strain and easy reading. You can independently change each monitor's height, tilt and swivel to increase your comfort level, add to your productivity, and better ensure proper ergonomic posture.

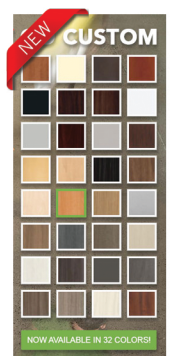



MultiTable® Single Monitor Arm

DIMENSIONS AND RANGE:

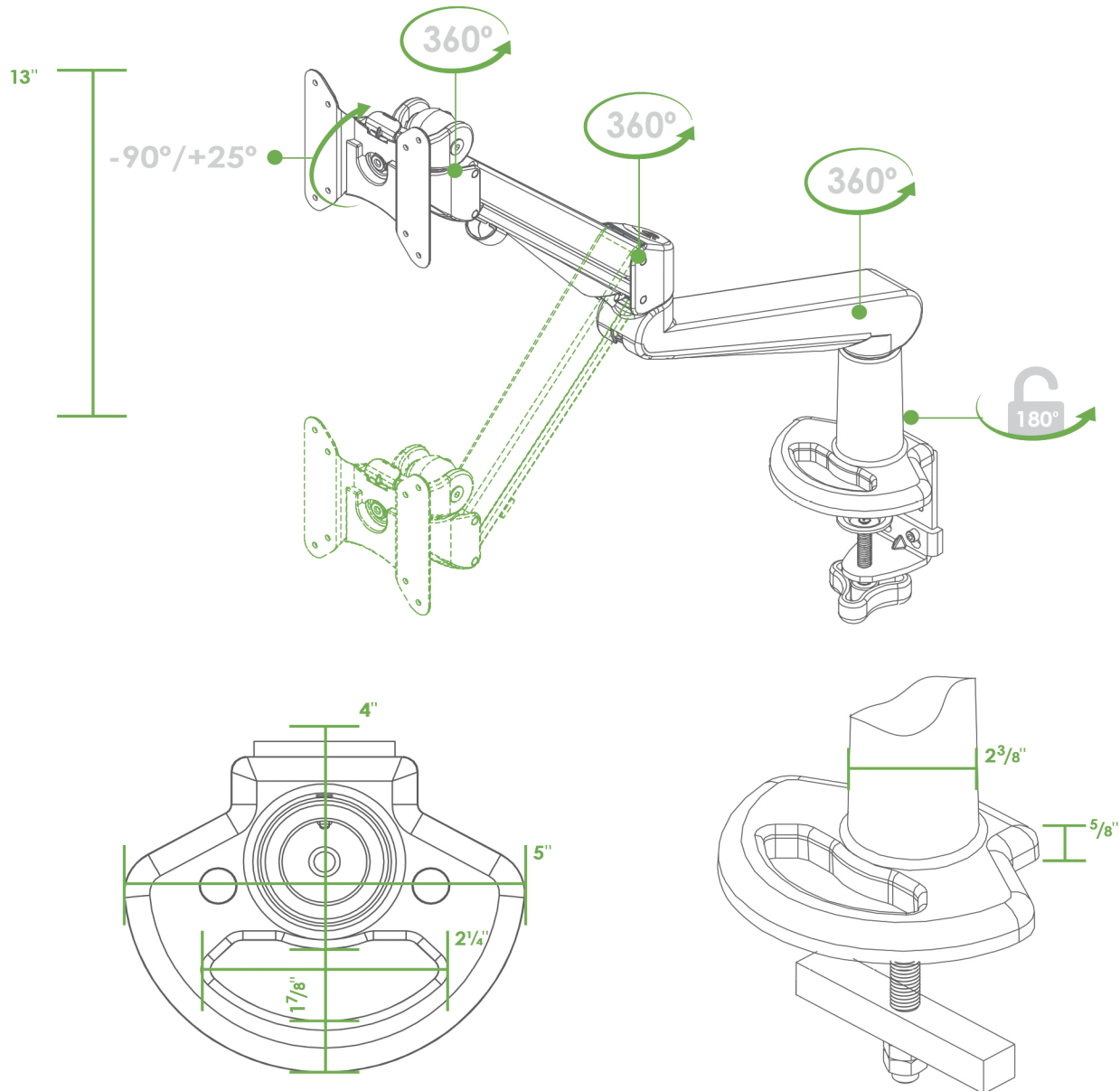

Monitor Quick Release

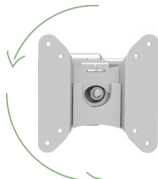

Landscape/Portrait Rotation



Cable Management



Grommet Mount



Desk Clamp



Integrated Allen Wrench Storage